



Wellington

Indoor Community Sports Centre

Presentation for CCG, July 2010



● Context, Site and Exterior Form

○ Interior and Sports Functionality

○ Building Fabric and ESD

- Roof
- Walls
- Floor
- ESD

Wellington

Indoor Community Sports Centre

- 
- 12 indoor courts for netball, basketball, volleyball and other codes
 - Community sports centre for improving the playing and training conditions for indoor sports at all skill levels
 - Cater for wide range of groups in the community with particular emphasis on pre-school age, youth and older adults.
 - Improve health and well being of the community by increased participation in sport and recreation.

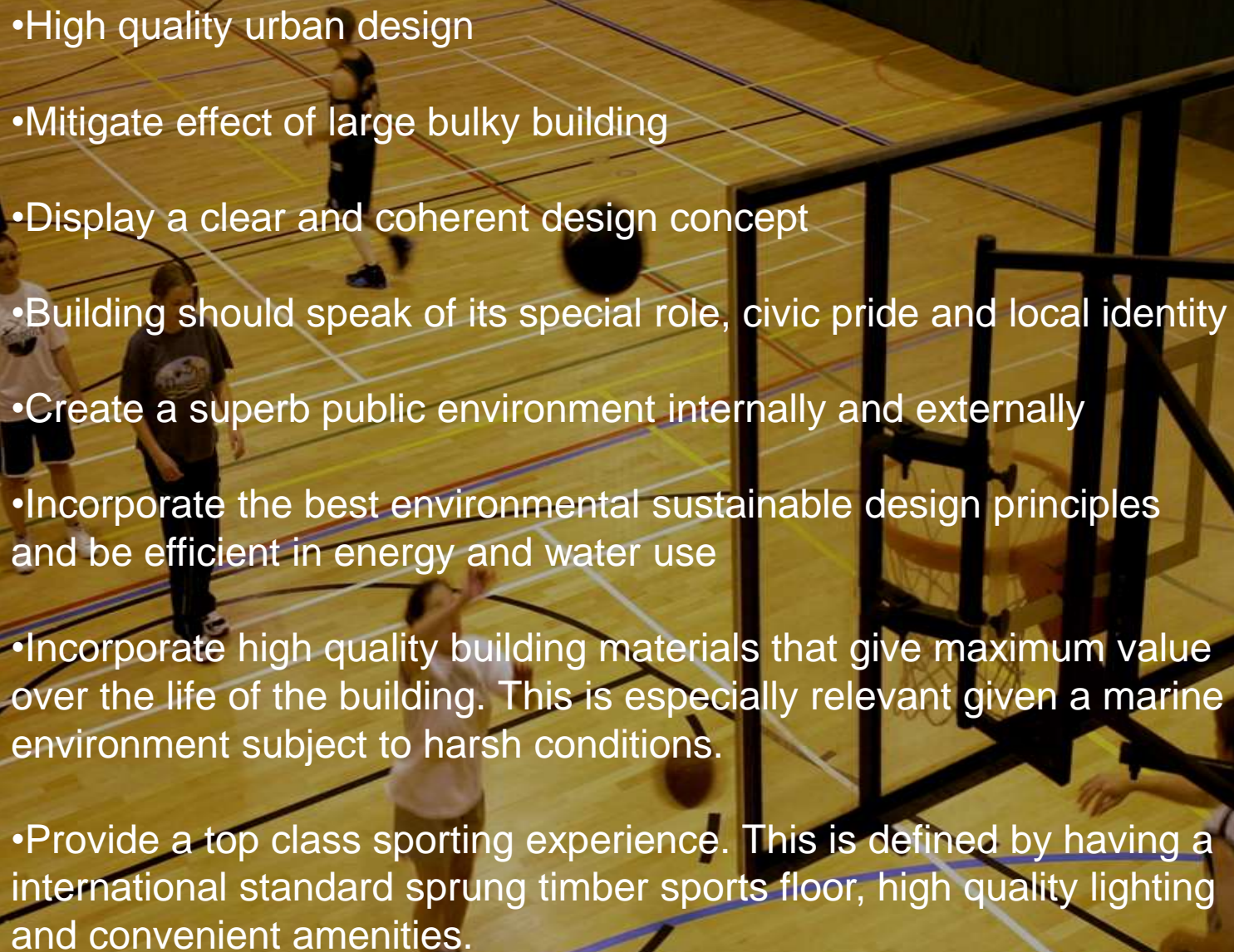
- 
- High quality urban design
 - Mitigate effect of large bulky building
 - Display a clear and coherent design concept
 - Building should speak of its special role, civic pride and local identity
 - Create a superb public environment internally and externally
 - Incorporate the best environmental sustainable design principles and be efficient in energy and water use
 - Incorporate high quality building materials that give maximum value over the life of the building. This is especially relevant given a marine environment subject to harsh conditions.
 - Provide a top class sporting experience. This is defined by having a international standard sprung timber sports floor, high quality lighting and convenient amenities.

- Maritime form – shell/crustacean
- Large scale but suitably sited in centre of bay
- Major gateway building – airport to city

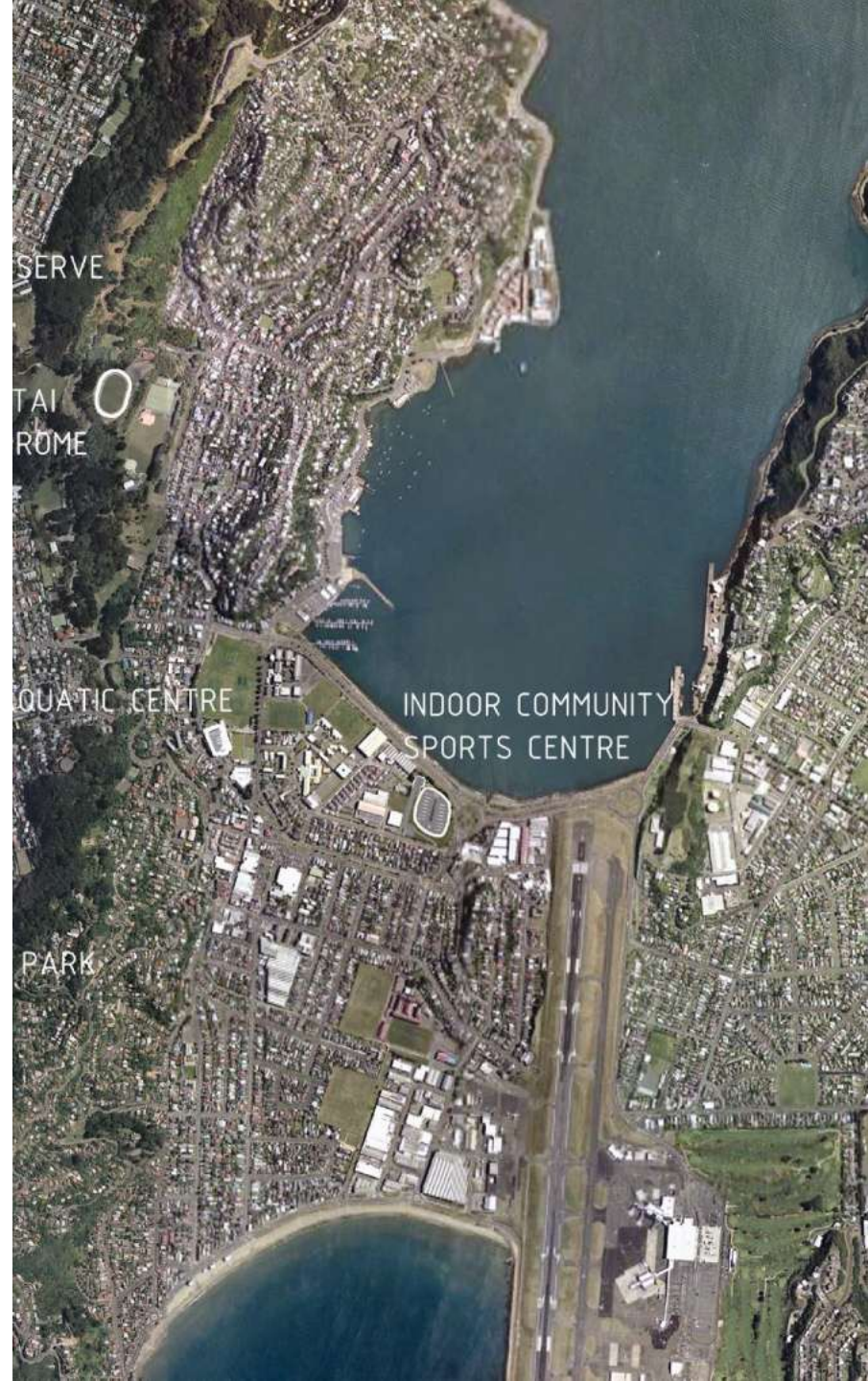

Evans Bay Aerial



Aerial View: *North East*



Illustration by www.stantialstudio.co.nz ©

Forecourt View





Illustration by www.stantialstudio.co.nz ©

Kemp Street View





Aerial View: *East*

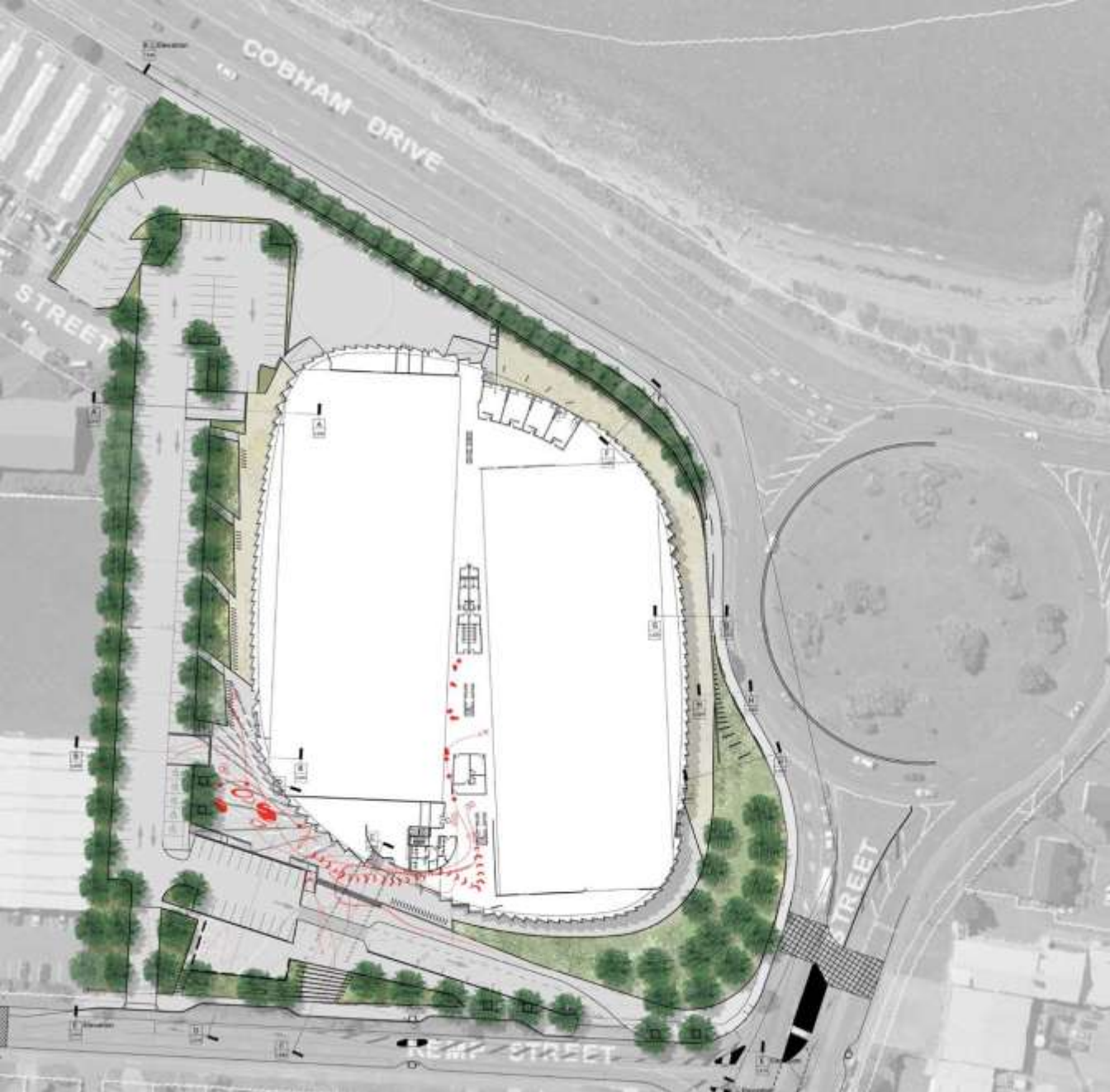



LANDSCAPE COMPONENTS

SURFACING

-  ASPHALT SURFACING (011) - AVIS
-  SUPERGRAPHIC ON ASPHALT (011)
-  LANDSCAPE PEDESTRIAN PATH (011)
-  PAINTED PEDESTRIAN CROSSING
-  PEDESTRIAN RAMP (011)
-  VEHICLE RAMP (011)
-  CONCRETE STAIRS (011) - LINES

PLANTING

-  LANDSCAPE BED (011)
-  TREE PITS WITHIN GARDEN BEDS (011) - 100'
-  TREE PITS WITHIN HARD SURFACING (012) - 100'

- Running track around building
- Half court for recreation and gathering
- Wind mitigation integrated into landscape design

Site Plan and Landscape

Context, Site and Exterior Form

Interior and Sports Functionality

Building Fabric and ESD

- Roof

- Walls

- Floor

- ESD

Wellington

Indoor Community Sports Centre



- GFA 15800m²
- Ground Floor 12600m²
- Mezzanine 3200m²
- Undercroft 4,500m²
- Max height 15m

----- Divider curtains

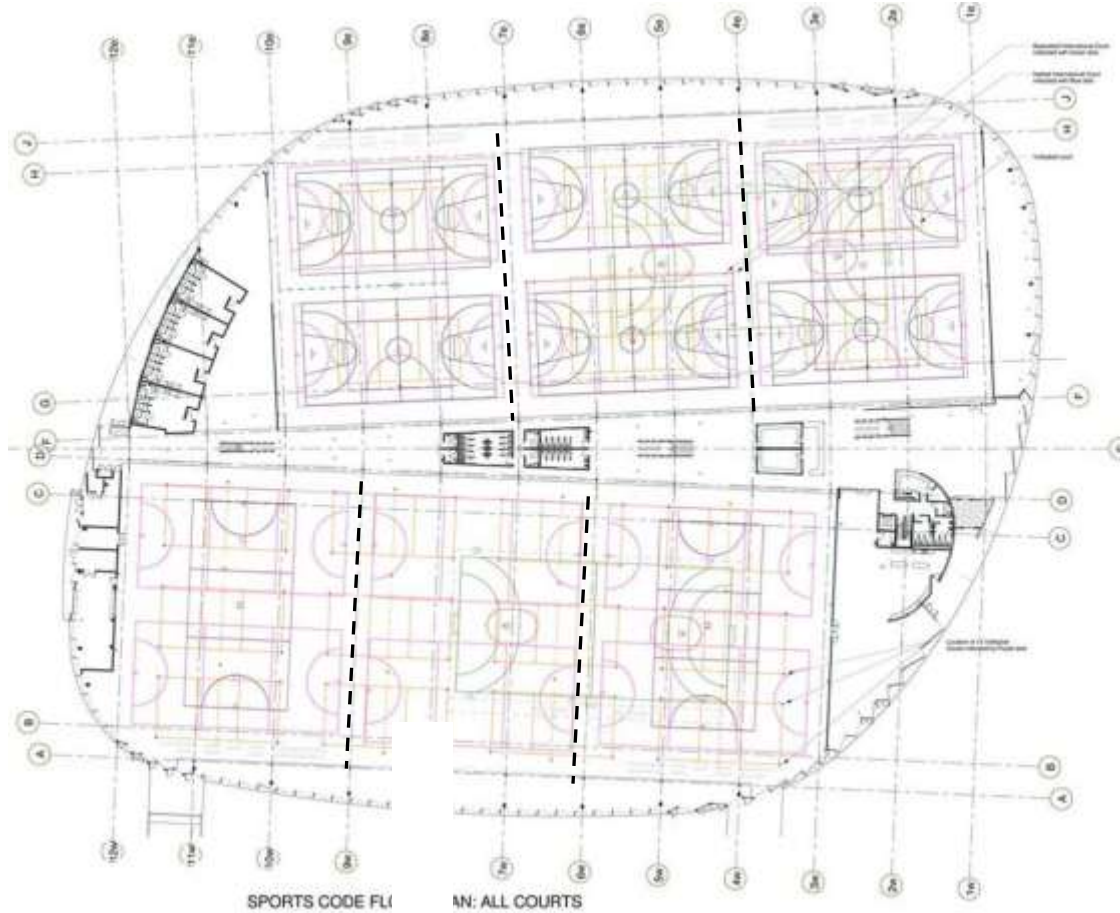

Sports Codes Floor Plan: *All Codes have signed off layout*

Seating: 300 fixed seats
400 loose seats (min)

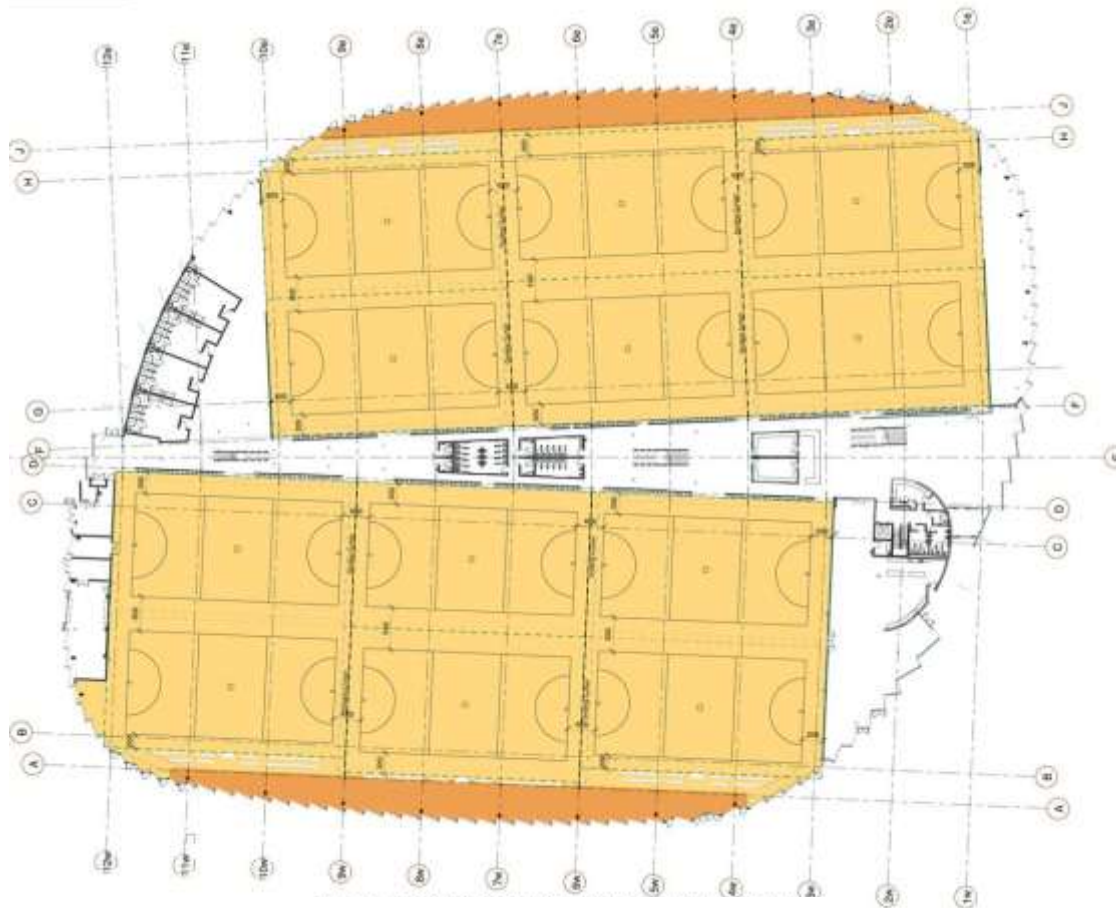

Netball: 12 courts for local competition and training

Seating: 1842 roll-out seating

200 corner seats

180 mezzanine

Total: 2222 seats

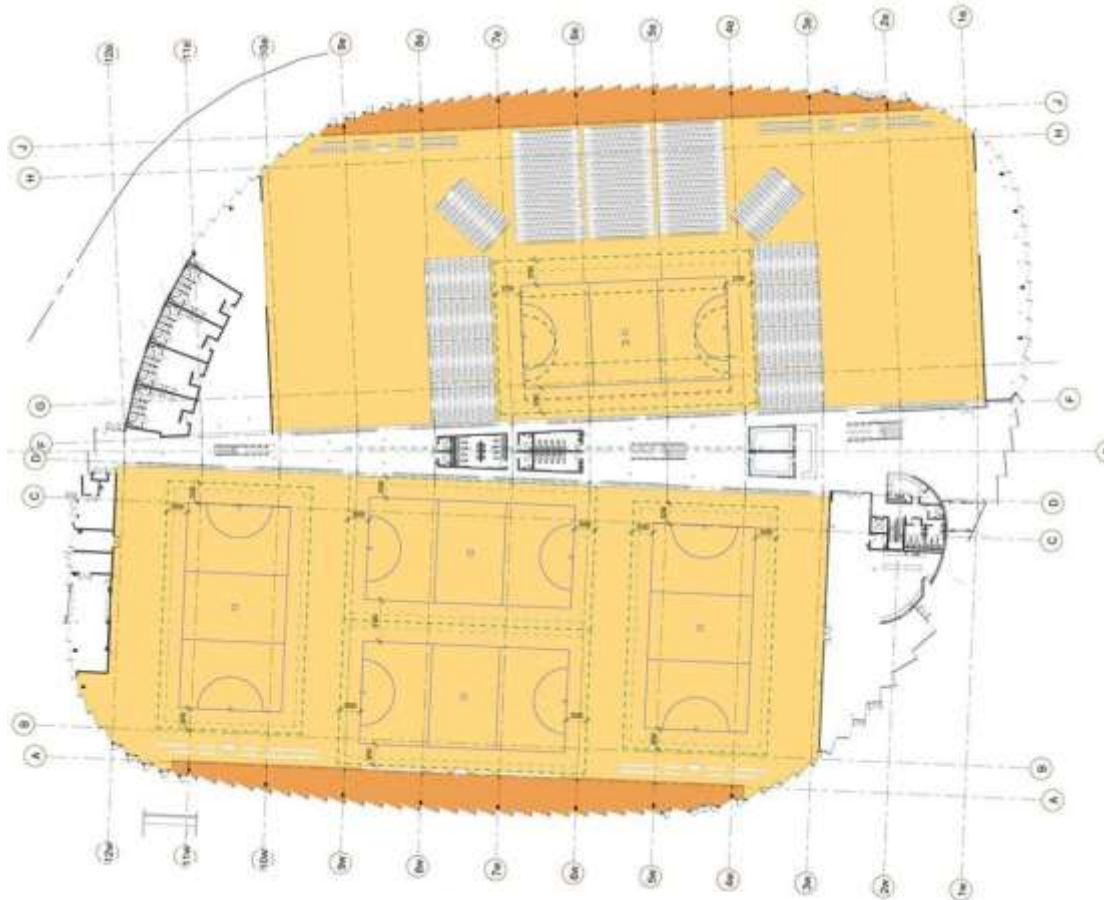

Netball: *International court and temporary spectator seating*

Seating: 4000

Tables: 400

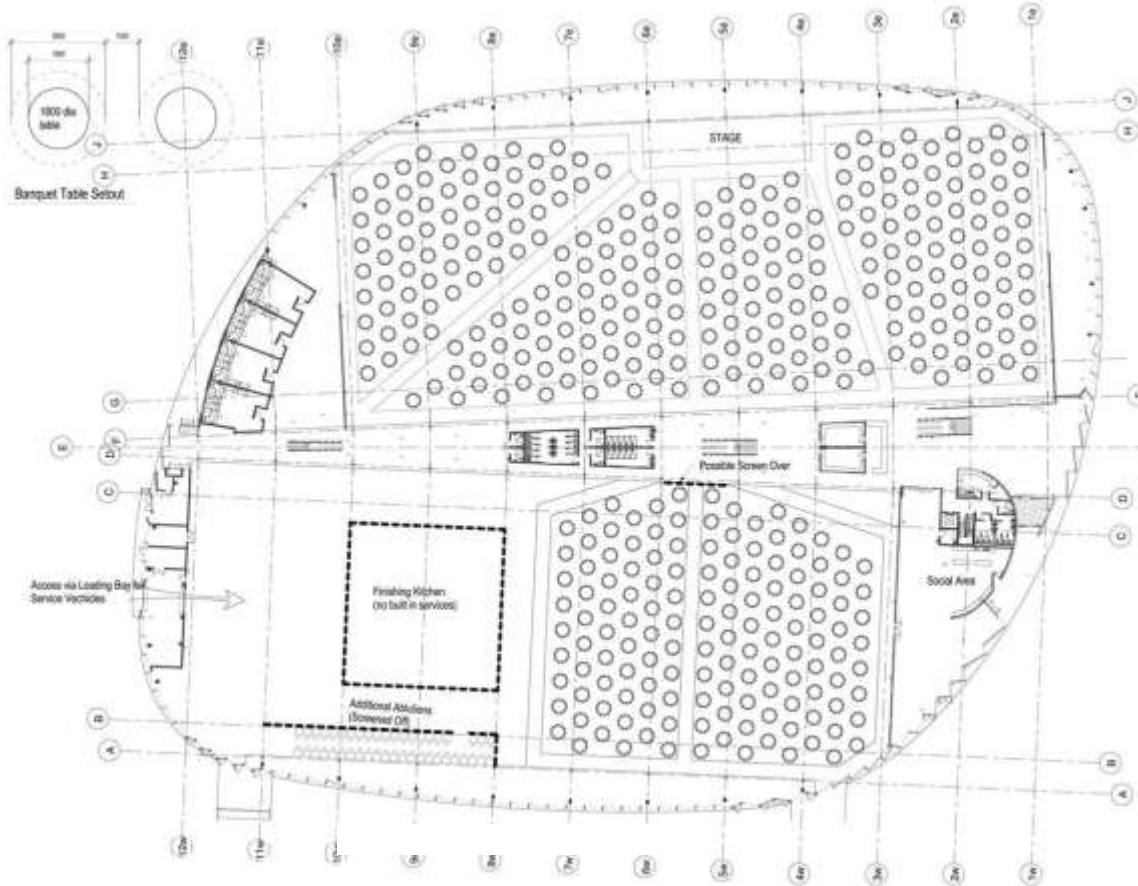

Banquet: Seating for 4000 people